

Official Nursery/Landscape CDE Drop Sheet

#	Plant/Tool/Disease	#	Plant/Tool/Disease	#	Exam	#	Exam	#	Practicum
1.	076	31.	061	1.	C	26.	B	1.	B
2.	068	32.	087	2.	C	27.	B	2.	A
3.	030	33.	119	3.	A	28.	C	3.	C
4.	036	34.	100	4.	A	29.	A	4.	B
5.	139	35.	140	5.	D	30.	D	5.	A
6.	001	36.	069	6.	B	31.	B	6.	A
7.	117	37.	008	7.	D	32.	B	7.	D
8.	075	38.	115	8.	B	33.	D	8.	A
9.	091	39.	003	9.	C	34.	D	9.	C
10.	102	40.	167	10.	C	35.	B	10.	D
11.	012	41.	014	11.	D	36.	C		
12.	183	42.	099	12.	D	37.	D		
13.	077	43.	169	13.	D	38.	A		
14.	052	44.	056	14.	D	39.	C		
15.	089	45.	023	15.	A	40.	A		
16.	043	46.	120	16.	C	41.	D		
17.	142	47.	073	17.	C	42.	C		
18.	035	48.	040	18.	C	43.	D		
19.	166	49.	010	19.	A	44.	A		
20.	111	50.	067	20.	C	45.	C		
21.	042	51.	133	21.	C	46.	A		
22.	022	52.	131	22.	D	47.	C		
23.	032	53.	059	23.	D	48.	A		
24.	098	54.	025	24.	C	49.	B		
25.	002	55.	018	25.	B	50.	A		
26.	168	56.	101						
27.	097	57.	107						
28.	041	58.	033						
29.	019	59.	063						
30.	064	60.	079						

Practicum
ID Total
Exam
Keep/Cull
TOTAL



Keep/Cull Class #1 (1 2 0 2 5 3 4 4 9 5 6 6 3 7 2 8 15) Officials	
K 1 4 5 8	C 2 3 6 7
Indiv. Points	_____
1. See Keep Cull Page Before	2.
3.	4.
5.	6.
7.	8.
Keep/Cull Class #2 (1 2 2 9 3 16 4 5 5 19 6 3 7 1 8 6) Officials	
K 2 3 5 8	C 1 4 6 7
Indiv. Points	_____
1.	2.
3.	4.
5.	6.
7.	8.
Keep/Cull Class #3 (1 3 2 1 3 17 4 9 5 12 6 10 7 5 8 1) Officials	
K 2 3 5 6	C 1 4 7 8
Indiv. Points	_____
1.	2.
3.	4.
5.	6.
7.	8.
Keep/Cull Class #4 (1 2 2 7 3 14 4 4 5 5 6 16 7 13 8 3) Officials	
K 2 3 6 7	C 1 4 5 8
Indiv. Points	_____
1.	2.
3.	4.
5.	6.
7.	8.

1  
2  
3  
4

# FFA CDE Key 05 Mar 2022

①  $36.75 \text{ ft} \times 16 \text{ ft} = 588 \text{ ft}^2$  B

② Main =  $27.5 \text{ ft} \times 2.25 \text{ ft} = 61.875 \text{ ft}^2$

Left Triangle =  $\frac{1}{2} (0.5 \text{ ft})(2.25 \text{ ft}) = 0.5625 \text{ ft}^2$

Right Triangle =  $\frac{1}{2} (8.5 \text{ ft})(2.25 \text{ ft}) = 9.5625 \text{ ft}^2$   

---

 $72 \text{ ft}^2$  A

③ From #2

$72 \text{ ft}^2 \times 8 \text{ in} \times \frac{1 \text{ ft}}{12 \text{ in}} = \frac{48 \text{ ft}^3}{2 \text{ ft}^3/\text{bag}} = 24 \text{ bags}$  C

④ Lagerstroemia width =  $11.75 \text{ ft}$  B

⑤ Aluminium

(pg 6-3, 3rd paragraph) A

⑥	A	1 × \$14 = \$14	F	1 × \$35 = \$35
	B	7 × \$5 = 35	G	5 × \$25 = \$125
	C	10 × \$5 = 50	H	3 × \$4 = \$12
	D	12 × \$3 = 36	I	10 × \$8 = \$80
	E	5 × \$9 = 45	J	3 × \$30 = \$90
				<hr/>
				\$522

A

⑦ From #1      588 ft<sup>2</sup>       $\frac{1.25 \text{ lbs}}{100 \text{ ft}^2} = \frac{x}{516 \text{ ft}^2}$

From #2       $\frac{72 \text{ ft}^2}{516 \text{ ft}^2}$       x = 6.45 lbs

D

⑧ 0.5 lbs 15-5-15 = 5% P<sub>2</sub>O<sub>5</sub>

15-15-15 = 15% P<sub>2</sub>O<sub>5</sub>, 3x as potent

Thus, apply less. (6-9, 1st paragraph) A

⑨ 50 lbs ×  $\frac{0.15 \text{ lb K}_2\text{O}}{1 \text{ lb } 15-5-15}$  ×  $\frac{0.83 \text{ lb K}}{1 \text{ lb K}_2\text{O}}$  = 6.2 lbs K C

⑩ Low cost (6-6, table) D

# Agriculture Building

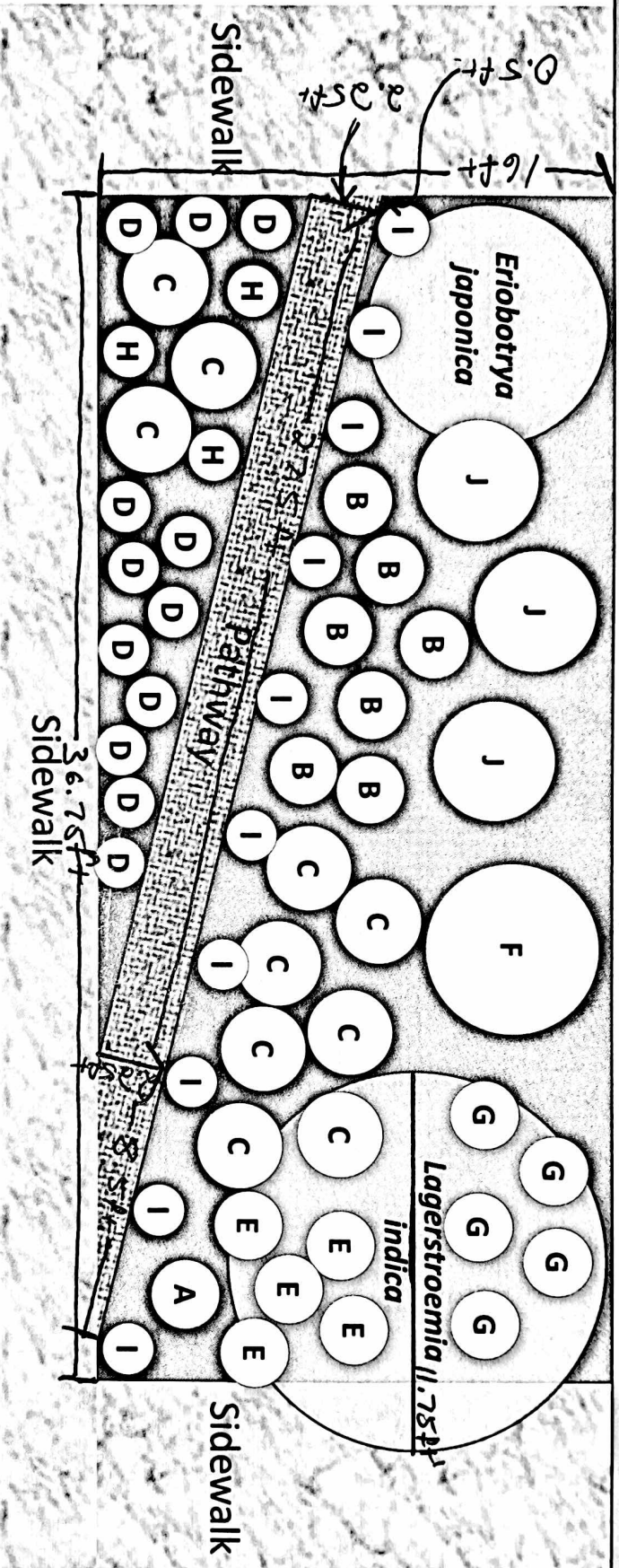

Street



Please use the point values on the drop sheet.

Rank A = 1st place, Rank H = 8th place

<b>SHRUBS</b>	<b>TABLE 1 ILEX</b>	<b>RANK</b>
1	More lopsided growth and openness.	F
2	C has less vigor than A-B	C
3	Slightly lopsided, but still good growth in the center of the plant	D
4	Plant death on one side	H
5	Even more open openness than F	G
6	Good spherical growth. Center is full of growth.	A
7	Openness in the plant	E
8	Slightly smaller than A, still good growth	B

<b>GROUNDCOVERS 2</b>	<b>TABLE 2 OPHIOPOGON</b>	<b>RANK</b>
1	More yellowing than A-C	D
2	Similar vigor to A, few yellow tips	B
3	Smaller, more yellow tips than above	F
4	Has most yellow tips on leaves.	H
5	Green growth, little to no yellowing	A
6	Smaller, more yellow tips than A-B	C
7	Smaller, more yellow tips than A-D, smaller	E
8	Smaller, more yellow tips than above	G

<b>GROUNDCOVERS 1</b>	<b>TABLE 3 HEDERA</b>	<b>RANK</b>
1	Most blackening discoloration on the leaves.	H
2	Very good vigorous growth, multiple runners	A
3	Even more black damage than E and F	G
4	Little black damage on two tips of leaves	E
5	Two vigorous runners, lopsided	C
6	More black damage than E	F
7	Good growth, smaller than A-C	D
8	Good vigorous growth, slightly smaller than A	B

<b>ANNUALS</b>	<b>TABLE 4 VIOLA</b>	<b>RANK</b>
6	Good green growth and flowers	A
1	Good green growth and flowers, slightly more compact	C
2	Slight yellowing on one lower leaf	E
3	Smaller, more yellowing on the lower leaves	G
4	Smaller, but still good green color	D
5	Slightly smaller than plant B	B
7	Significant yellowing on the entire plant, scraggly growth	H
8	Three yellow lower leaves	F