

### Official Nursery/Landscape CDE Drop Sheet

#	Plant/Tool/Disease	#	Plant/Tool/Disease
1.	163	31.	026
2.	123	32.	076
3.	098	33.	097
4.	023	34.	089
5.	012	35.	030
6.	083	36.	111
7.	067	37.	087
8.	032	38.	100
9.	107	39.	064
10.	118	40.	084
11.	052	41.	011
12.	068	42.	136
13.	131	43.	061
14.	099	44.	059
15.	121	45.	002
16.	033	46.	018
17.	041	47.	003
18.	079	48.	040
19.	135	49.	063
20.	102	50.	065
21.	120	51.	119
22.	153	52.	101
23.	008	53.	042
24.	183	54.	014
25.	007	55.	056
26.	117	56.	025
27.	127	57.	077
28.	115	58.	140
29.	133	59.	069
30.	036	60.	139

#	Exam	#	Exam
1.	C	26.	C
2.	B	27.	C
3.	C	28.	C
4.	D	29.	C
5.	A	30.	B
6.	A	31.	B
7.	B	32.	C
8.	B	33.	D
9.	C	34.	C
10.	C	35.	C
11.	A	36.	A
12.	B	37.	D
13.	C	38.	D
14.	B	39.	A
15.	B	40.	D
16.	A	41.	B
17.	C	42.	C
18.	D	43.	B
19.	C	44.	D
20.	C	45.	C
21.	D	46.	C
22.	B	47.	B
23.	B	48.	C
24.	B	49.	B
25.	C	50.	D

#	Practicum
1.	B
2.	C
3.	B
4.	D
5.	B
6.	A
7.	D
8.	B
9.	C
10.	C

<b>Practicum</b>
<b>ID Total</b>
<b>Exam</b>
<b>Keep/Cull</b>
<b>TOTAL</b>

SEE BELOW FOR  
KEEP/CULL



# SFA FFA Key 2022

$$\textcircled{1} 18.66 \text{ ft} \times 7.5 \text{ ft} \times 4 \text{ beds} = 559.8 \text{ ft}^2 \quad \boxed{B}$$

$$\textcircled{2} \text{ Beds 1-4 } \frac{1}{2} (18.66 \text{ ft} \times 18.66 \text{ ft}) \times 4 = 696.4 \text{ ft}^2$$

$$\text{Beds 5-8 } \frac{1}{2} (11.33 \text{ ft} \times 11.33 \text{ ft}) \times 4 = \frac{256.7 \text{ ft}^2}{953.1 \text{ ft}^2} \quad \boxed{C}$$

$$\textcircled{3} 48 \text{ ft} \times 48 \text{ ft} = 2304 \text{ ft}^2$$

$$\text{From \# 2} = \frac{953.1 \text{ ft}^2}{1350.9 \text{ ft}^2}$$

$$1350.9 \text{ ft}^2 \times 3 \times \frac{1 \text{ ft}}{12 \text{ in}} \times \frac{1 \text{ yd}^3}{27 \text{ ft}^3} = 12.5 \text{ yd}^3$$
$$= 13 \text{ yd}^3 \quad \boxed{B}$$

$$\textcircled{4} 10.66 \text{ ft} \times 15 \text{ ft} \times 4 \text{ paths} = 639.6 \text{ ft}^2$$

$$\frac{4 \text{ in}}{12 \text{ in/ft}} \times \frac{4 \text{ in}}{12 \text{ in/ft}} = 0.11 \text{ ft}^2$$

$$\frac{639.6 \text{ ft}^2}{0.11 \text{ ft}^2} = 5814.5 \text{ or } 5815 \text{ bricks}$$

Note, since 10.6 and 0.1 are repeating, calculations can vary.

$\boxed{D}$

5. Eriobotrya japonica [B]

$$\textcircled{6} \frac{0.6 \text{ lbs fert}}{100 \text{ ft}^2} = \frac{x}{953.1 \text{ ft}^2} \text{ (From \#2)}$$

$$x = \frac{0.6 \text{ lbs fert} (953.1 \text{ ft}^2)}{100 \text{ ft}^2} = 5.7 \text{ lbs fert}$$

S-2-2 [A]

$$\textcircled{7} 80 \text{ lbs fert} \times \frac{0.02 \text{ lb P}_2\text{O}_5}{1 \text{ lb fert}} \times \frac{0.44 \text{ lb P}}{1 \text{ lb P}_2\text{O}_5} = 0.7 \text{ lb P}$$

[D]

8. [B] Plant Nutrition p. 6-2, 2nd paragraph

9. [C] Plant Nutrition, p. 6-7, whole page

10. [C] Suther, p. 6-2 table

3/32 Scale

SFASU Herb Garden  
Design

By SFASU  
Horticulture Club

March 2022

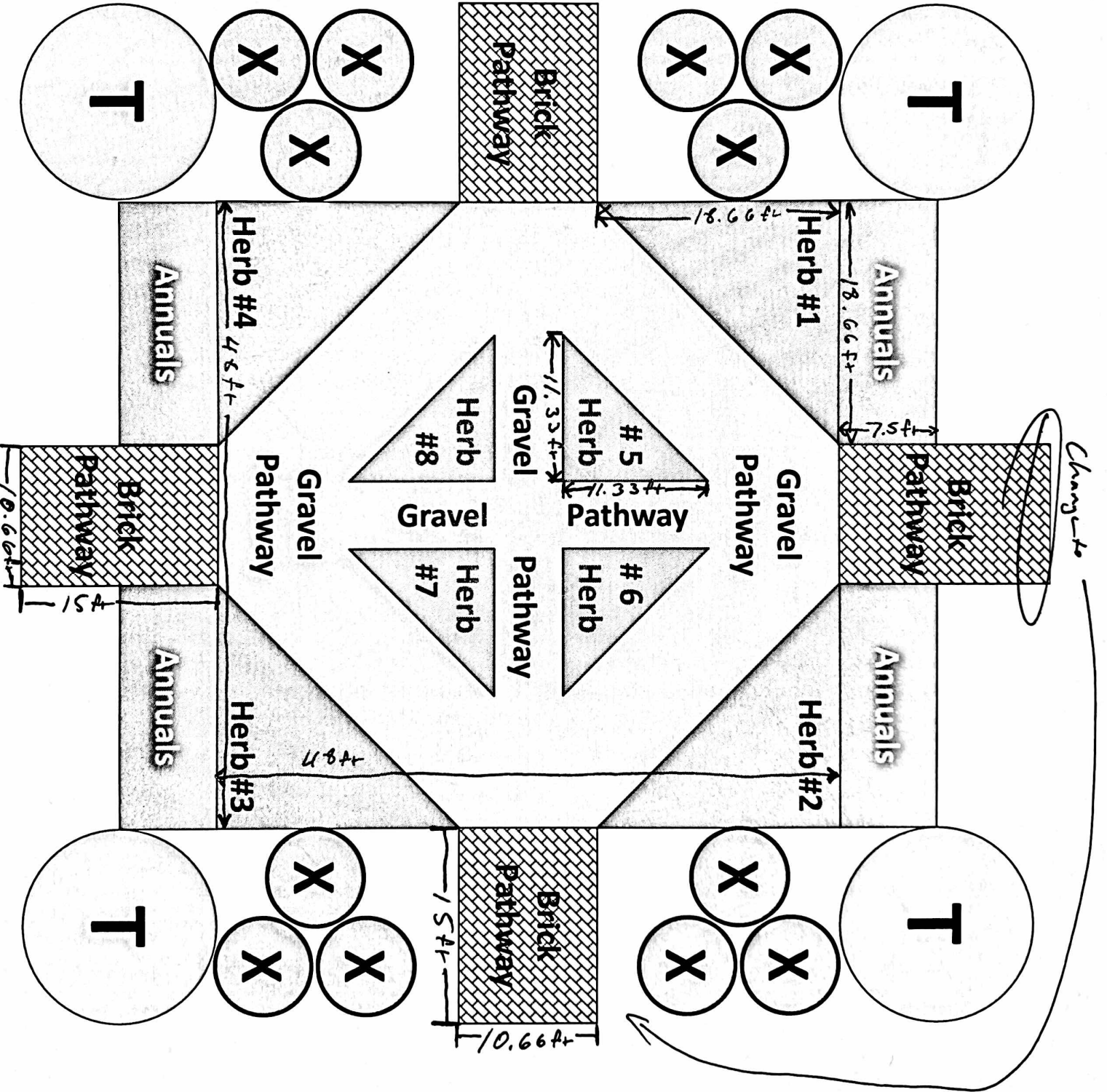

**FOR RANK, A IS BEST PLANT, AND H IS WORST PLANT**

<b>LABEL</b>	<b>RANK</b>	<b>K/C</b>	<b>PLANT / TABLE</b>	<b>PTS</b>
<b>ANNUALS 1</b>			<b>ZINNIA / TABLE 1</b>	<b>50</b>
7	A	K	Largest plant, vigorous growth	15
3	B	K	Similar to plant A. Slightly smaller.	14
5	C	K	Similar to plant AB. Slightly smaller.	13
2	D	K	Much smaller than A-C.	8
4	E	C	Some browning on lower leaves, less than F-H	6
8	F	C	F has one brown spot on lower leaves	5
6	G	C	G has two brown spots on lower leaves	3
1	H	C	H looks sad. Brown leaves and collapsing.	2
<b>GROUNDCOVERS</b>			<b>HEDERA / TABLE 2</b>	<b>50</b>
6	A	K	Good growth	15
4	B	K	Good growth, slightly smaller than A	14
5	C	K	Smaller than A and B, no damage	12
1	D	K	Smaller than A-C	9
7	E	C	Branch broken, but no browning visible	7
2	F	C	Browning on the foliage	6
3	G	C	More browning than F	4
8	H	C	Most browning on the foliage	2
<b>SHRUBS</b>			<b>ILEX / TABLE 3</b>	<b>50</b>
5	A	K	Good overall uniform growth	16
6	B	K	Slightly smaller than A	14
3	C	K	More irregular growth than A and B.	11
7	D	K	D slightly more lopsided than A-D	9
2	E	C	More irregular growth than D. One or two small brown spots.	7
8	F	C	Yellow leaf and a few brown spots	5
1	G	C	Irregular growth, yellowing	3
4	H	C	Has 5 large holes from decaying foliage within the leaf. Indicates major issues	2
<b>ANNUALS 2</b>			<b>BEGONIA / TABLE 4</b>	<b>50</b>
8	A	K	Good vigorous plant. Little to no damage.	16
3	B	K	Slightly less vigorous than A. Two very small white marks.	14
1	C	K	Similar vigor to A-B. Increased browning on lower leaves.	11
6	D	K	Similar vigor to A-C. Increased browning on lower leaves.	9
2	E	C	More lower-leaf browning than A-D	7
7	F	C	More lower-leaf browning than A-E	5
4	G	C	More lower-leaf browning than A-F	3
5	H	C	Most lower-leaf browning. Also damage on lower leaf.	2